



## Bathroom extract fans DECOR Series

### Serial DECOR

#### DECOR-100 C Z \*12V 50\* RE

Range of axial extractors with airflow rates of approx. 100 m<sup>3</sup>/h, for connection to 100 mm diameter circular ducting.

All the fans are manufactured from injection moulded plastic, fitted with neon light indicator and single phase 230V-50Hz, class B motor equipped with overload thermal protection. The "Z" versions incorporate long life motors fitted with ball bearings. All the fans are class II insulation, IP44 rated and suitable to operate with air temperature up to 40°C.



## Technical data

### Acoustic characteristics

No sound information available.

Hz	63	125	250	500	1k	2k	4k	8k	Overall
----	----	-----	-----	-----	----	----	----	----	---------

### Technical characteristics

#### Construction

Discharge diameter	98 mm
Fan size	100
Weight	0,44 kg

#### Motor Characteristics

Voltage	1-12V-50Hz
Maximum absorbed current	1,5 A
IP Rating	IPX4
Motor insulation class	B

### Curves

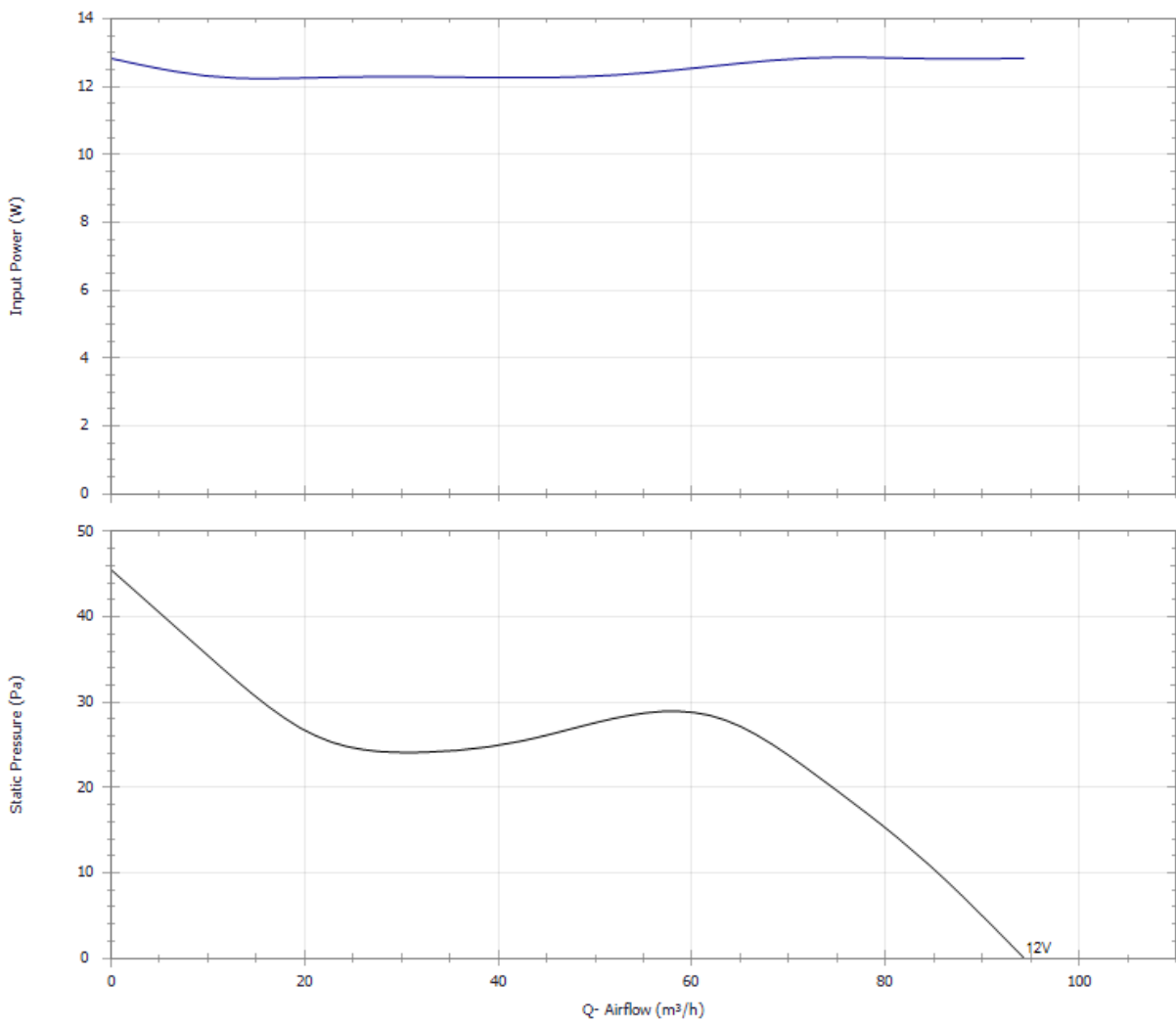

Dimensions

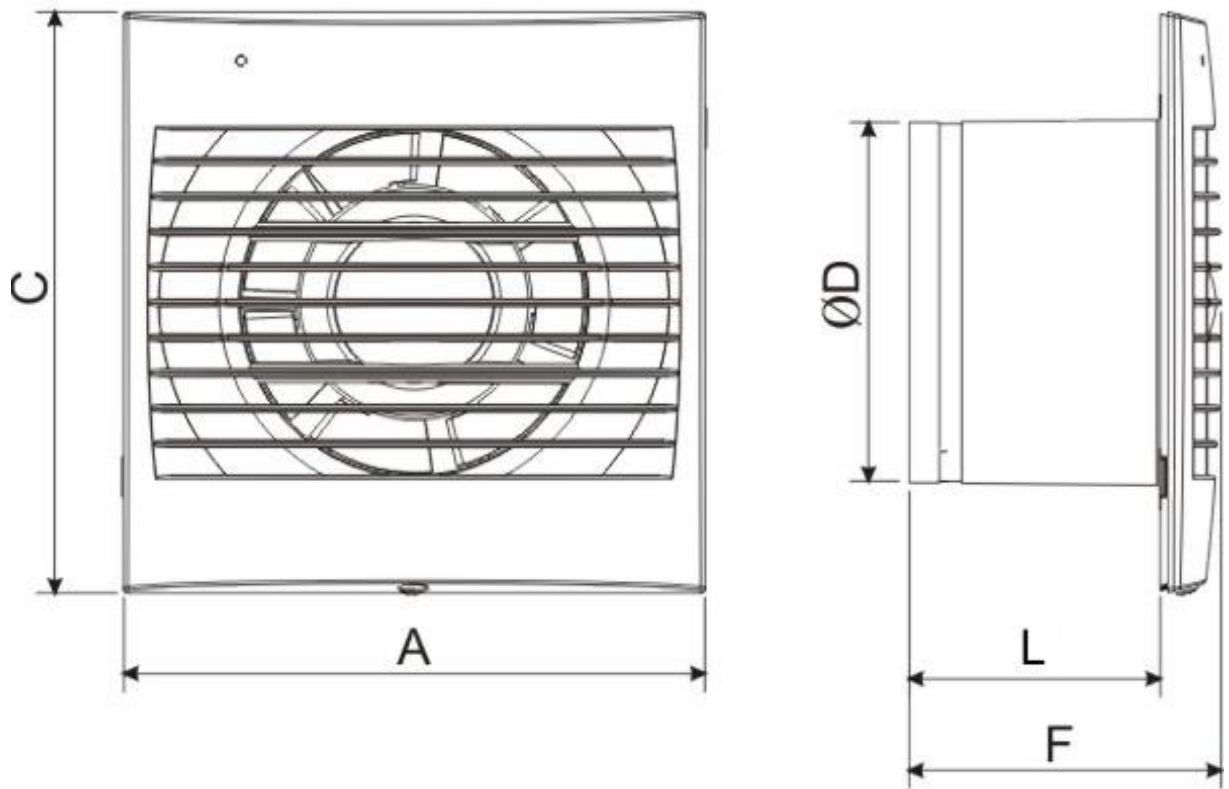

A	C	D	L	F
---	---	---	---	---

158	158	98	68	85
-----	-----	----	----	----

## Model Features

	C	CZ	CR	CRZ	CH	CHZ	CHZ VISUAL	CD	CDZ	12V C
NEON LIGHT INDICATOR	•	•	•	•	•	•	•	•	•	•
AUTOMATIC BACK DRAFT SHUTTER	•	•	•	•	•	•	•	•	•	•
ADJUSTABLE RUN-ON-TIMER			•	•	•	•	•	•	•	*
ADJUSTABLE HUMIDISTAT					•	•	•			
PIR DETECTOR								•	•	
BALL BEARINGS		•		•		•	•		•	

\* Using a CT-12/14 R transformer.

## ErP Information

<b>Ecodesign</b>	
<b>Commission regulation (EU) N°1253/2014 of July 2014</b>	
<b>Information requirements (Annex V)</b>	
<b>ProductoComercial</b>	DECOR-100 C Z *12V 50* RE
<b>Identifier</b>	5210110200
<b>www.solerpalau.com</b>	