



## Bathroom extract fans

### SILENT DESIGN ECOWATT Series

#### SILENT DESIGN ECOWATT

Range of axial extractors with airflow rates of approx. 85 m<sup>3</sup>/h, high-performance, lowconsumption Brushless motors, for connection to 100 mm diameter circular ducting. Motor mounted on silent-elastic-blocks which absorb the vibrations and allow offering very low noise level. All the fans are manufactured from injection moulded plastic, fitted with automatic shutter and single phase 230V-50/60Hz, low consumption motor equipped with thermal overload protection. All the fans are class II insulation, IP45 rated and suitable to operate with air temperature up to 40°C.

With consumption of only 5W, the SILENT ECOWATT series extractors are especially recommended toilets, bathrooms and installations where the extractor will require long working hours resulting in a considerable reduction in energy costs.

#### SILENT-100 DESIGN 12VDC ECOWATT + CT-12/6

Kit made up of SILENT-100 DESIGN 12VDC ECOWATT fan, fitted with 12VDC brushless motor and designed for operation at SELV, and a transformer CT-12/6.



#### Attributes



##### Back draft shutter

To prevent air entry and limit heat leakage when the extractor is not operating.

It opens due to the pressure of the air.



##### Silent-blocks

Motor mounted on "Silent-elastic-block" to prevent vibration and noise transmission.

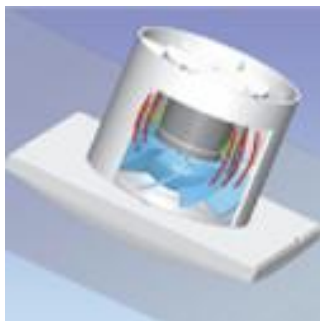

## SILENT-100 DESIGN ECOWATT

### **Quiet operation**

In usual extract fans the vibrations are transmitted to the surrounding areas while in SILENT extractor fans the vibrations are absorbed by the Silent Blocks.



### **Interchangeable bars colours**

Interchangeable bars colours let the fan blend in with every setting. 4 colours to match the decor of the room: blue, red, green and yellow.