



## Bathroom extract fans **SILENT Series**

### **SILENT**

Range of axial extractors with airflow rates of approx. 95 m<sup>3</sup>/h, for connection to 100 mm diameter circular ducting.

Motor mounted on silent-elastic-blocks which absorb the vibrations and allow offering very low noise level. All the fans are manufactured from injection moulded plastic, fitted with automatic shutter and single phase 230V-50Hz, class B low consumption motor equipped with thermal overload protection. All the fans are class II insulation, IP45 rated and suitable to operate with air temperature up to 40°C.

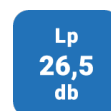

### **Attributes**



#### **Back draft shutter**

To prevent air entry and limit heat leakage when the extractor is not operating. It opens due to the pressure of the air.



#### **Silent-blocks**

Motor mounted on "Silent-elastic-block" to prevent vibration and noise transmission.

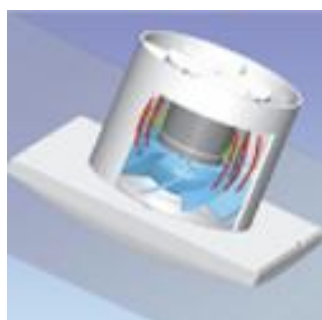

#### **SILENT-100**

##### **Quiet operation**

In usual extract fans the vibrations are transmitted to the surrounding areas while in SILENT extractor fans the vibrations are absorbed by the Silent Blocks.

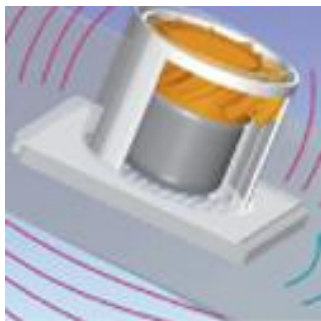

USUAL EXTRACTOR