

## Whole house extract unit PIV W Series

### PIV W

Ventilation unit that provides supply ventilation in dwellings whose distribution does not allow use of whole house ventilation system.

The unit draws air outdoors, passes air via its G4 filter and supplies it into the house via the hallway.

The unit includes 4 operating schemes with DC and low consumption motor, automatic regulation of airflows and electric battery that allows constant supply temperature.

#### Configuration:

- Anti-insect G4 filter.
- Electric battery of 500 W.
- Fan with DC motor.
- 1 fixing kit (screw and silent-blocks).



## Technical data

### Technical characteristics

Model	Voltage (V)	Motor	Absorbed power at free discharge (W)	Heating battery power (W)	Maximum airflow (m <sup>3</sup> /h)	Sound pressure level radied at 3 m (dB(A))	Protection/Insulation
PIV W	230	CC	11	500	112	28	IP20 / Clase II

### Curves

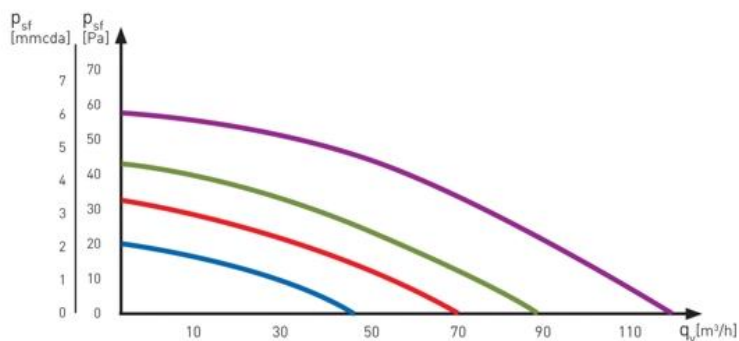

### Dimensions

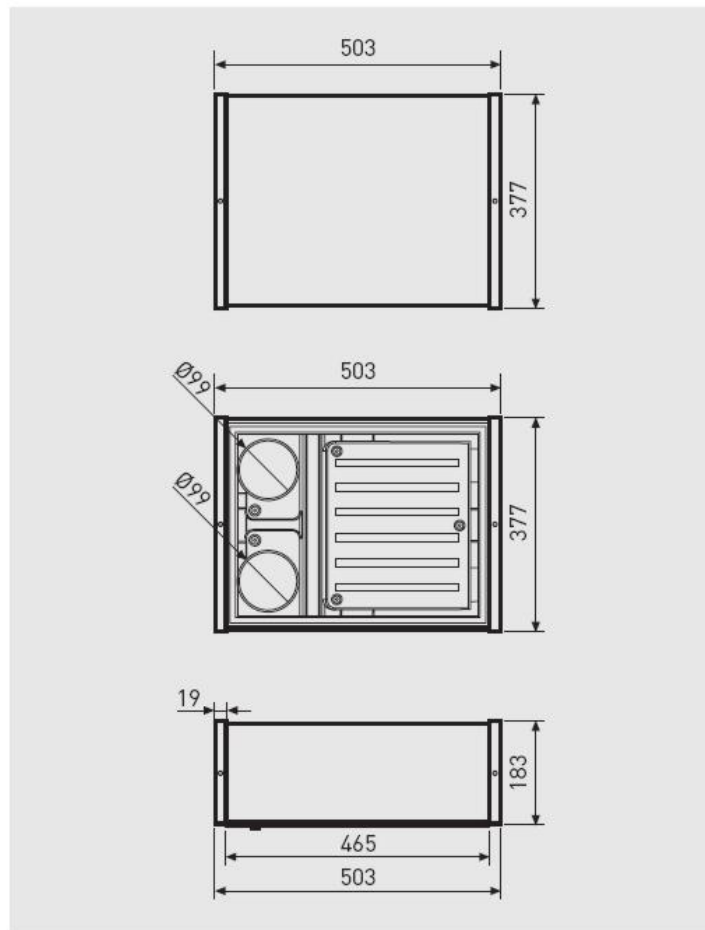

## Installation

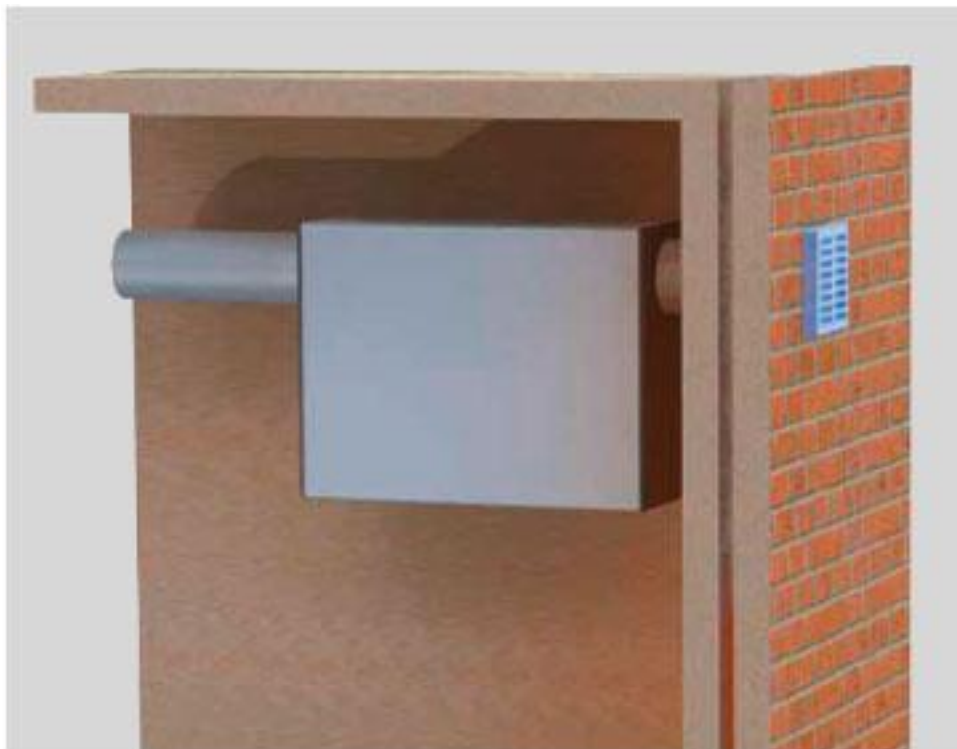

PIV W unit takes the air from the façade (preferably oriented to south), passes air via a anti-insect filter and supplies it into the dwelling via hallway.

## Operation

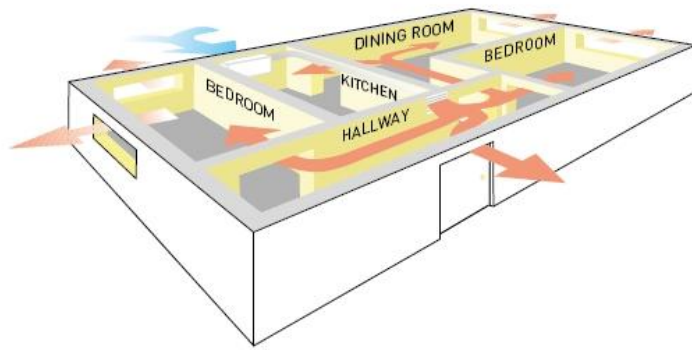

---

### ADVANTAGES

- Easy to mount, it does not require complex construction.
- Filtering of the air supplied into the house.
- Self-regulation of temperatures according to outdoor conditions.