

At S&P we design our products with ease of installation in mind.

The JETLINE in-line extract fan range is designed to save time, tools and hassle. It is that easy.



3 MOUNTING STEPS

1. Using the mounting bracket supplied, mark the fixing points where the product will be placed. Insert screws.

Adaptive mounting bracket with only two screws.

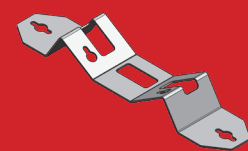

2. Place the mounting bracket in position taking into account the location of the terminal box.

Two mounting positions



3. Fix the product and mounting bracket securely in the previous marked place.

MORE COMPACT*

Compact design with an incredibly low profile to enable ease of installation into the smallest of spaces.

The terminal box and the mounting bracket do not increase the product profile.



New JETLINE

Existing centrifugal in-line fan

ZERO COMPLICATIONS

Designed with rubber gaskets on the flanges to simplify the connection and reduce air leakage.



JETLINE

PERFORMANCE AND POWER IN A VERY LOW PROFILE



S&P SISTEMAS DE VENTILACIÓN, S.L.U.

HEADQUARTERS:

C/ Llevant, 4

Polígono Industrial Llevant

08150 Parets del Vallès

Barcelona - Spain

www.solerpalau.com

consultas@solerpalau.com

Technical Advisory Service

Tel.: 901 11 62 25

Fax: 901 11 62 29

Soler&Palau
Ventilation Group

Soler&Palau
Ventilation Group

R406104335

JETLINE

Quieter than any centrifugal in-line fan

70% LESS AIR INLET - AND - RADIATED NOISE

30% MORE COMPACT

20% MORE EFFICIENT



Quiet air quality

High performance

Optimised design of the impeller and guide vanes to increase performance and lower the sound level.

Its revolutionary mixed-flow propeller produces high pressure similar to centrifugal impellers.

Integrated outlet diffuser

Integrated outlet diffuser optimizing air circulation to increase airflow efficiency and reduce in-duct sound level.

Airtightness

Airtight joint between the galvanised and plastic casings to avoid air leakage. Rubber gaskets on the flanges to improve airtightness when connecting to ductwork.

Silent-block

Silent-block between the motor and the casing to reduce the motor's vibrations and lower the sound level of the fan.

AC MODELS

A two pole AC motor suitable for voltage speed control and integrated manual reset overload protection with manual reset.
220-240V | 50/60Hz | -20/60°C | Cl. F | IP 44

ECOWATT MODELS

Incorporating an EC motor with adjustable speed via the potentiometer located within the terminal box. Alternatively, can be controlled via an external REB-ECOWATT controller, or an analogue input to control the JETLINE device with an external 0-10V signal.
230V±10% | 50/60Hz | -20/40°C | Cl. B | IP 44

THE QUIET PERFORMANCE FAN

A range of circular duct fans, designed for high aerodynamic performance with a compact profile and low sound level.

The range includes 7 models with an airflow range between 260 -1600m³/h

Model type	Speed (rpm)	Maximum absorbed power (W)	Maximum absorbed current (A-230V)	Maximum air volume (m ³ /h)	Sound pressure level* (dB(A))			Max. Air temp (°C at 50Hz)	Weight (kg)
					Inlet	Radiated	Outlet		
JETLINE-100	2690 / 2990	19 / 26	0,1 / 0,1	260 / 300	41 / 43	22 / 29	39 / 41	-20 / +60	3
JETLINE-125	2640 / 2940	40 / 52	0,2 / 0,2	420 / 480	47 / 49	25 / 31	47 / 49	-20 / +60	3,4
JETLINE-150	2730 / 3090	83 / 116	0,4 / 0,5	750 / 810	52 / 55	31 / 33	50 / 53	-20 / +60	4,5
JETLINE-160	2730 / 3080	84 / 117	0,4 / 0,5	760 / 850	52 / 55	31 / 32	51 / 54	-20 / +60	4,5
JETLINE-200	2630 / 2800	126 / 176	0,5 / 0,8	1080 / 1190	58 / 58	42 / 43	55 / 56	-20 / +60	5,6
JETLINE-250	2710 / 3050	160 / 231	0,7 / 1,0	1280 / 1470	59 / 61	45 / 47	58 / 61	-20 / +60	6,5
JETLINE-315	2600 / 2670	215 / 253	0,9 / 1,0	1610 / 1760	61 / 61	49 / 44	60 / 63	-20 / +60	8,4

Technical characteristics at 230V - 50 Hz / 60 Hz.

*Sound pressure level measured at 1.5 m free field condition, at a middle point of the performance curve.

Model type	Input tension regul. (V)	Speed (r.p.m.)	Maximum absorbed power (W)	Maximum absorbed current (A)	Maximum air volume (m ³ /h)	Sound pressure level* (dB(A))			Weight (kg)
						Inlet	Rad.	Outlet	
JETLINE-100 ECOWATT	10	2650	16	0,1	260	41	20	41	2,5
	4	1230	4	0,1	120	25	<20	24	
JETLINE-125 ECOWATT	10	2650	26	0,2	390	45	26	45	2,8
	4	1240	8	0,1	310	35	<20	35	
JETLINE-150 ECOWATT	10	2650	58	0,5	680	51	33	51	3,6
	4	1240	8	0,1	310	35	<20	35	
JETLINE-160 ECOWATT	10	2650	60	0,5	720	51	33	51	3,6
	4	1240	8	0,1	330	35	<20	35	
JETLINE-200 ECOWATT	10	2630	109	0,8	1050	55	38	55	4,7
	4	1250	15	0,1	490	39	22	39	
JETLINE-250 ECOWATT	10	2740	135	0,9	1270	58	41	57	5,8
	4	1290	22	0,2	580	42	24	41	
JETLINE-315 ECOWATT	10	2640	194	1,30	1570	61	45	60	8
	4	1260	30	0,2	740	45	29	44	

*Sound pressure level measured at 1,5m in free field conditions, at a middle point of the performance curve.

More information about Jetline:



	A	B
JETLINE 100	Ø100	190
JETLINE 125	Ø125	214
JETLINE 150	Ø150	252
JETLINE 160	Ø160	252
JETLINE 200	Ø200	261
JETLINE 250	Ø250	301
JETLINE 315	Ø315	331



1. BUILT-IN JUNCTION BOX

Built-in, IP65 terminal box that does not add to the overall height dimensions.
AC version (1 cable gland), ECOWATT version (2 cable glands).

2. SEALS

Rubber gaskets providing an airtight seal for ducted systems.

3. HIGH PERFORMANCE IMPELLER

New impeller geometry for reduced sound levels and greater performance.

4. GUIDE VANES

Optimised motor support with guide vanes designed and positioned to increase performance and lower sound levels.